

WIFI 1080P Sports Cam Q20 Instructions



FHD
1920x1080

160°
WIDE
ANGLE

32GB
micro
SD

Wifi

LOOP

Download on the
App Store

ANDROID APP ON
Google play

Precautions

- **Please charge 3 hours after receiving the product.**
- Do not remove the micro SD card during the shutdown process to avoid data damage.

【About Micro SD Card】

- Please use a micro SD card of Class10/U1, 16GB or higher. This device supports up to 32GB Micro SD card.
- Recorded in Micro SD card as follows:

(For reference only)

micro SD Card	1080P 30fps
16GB	110 mins
32GB	220 mins

(This video is related to the storage space of the memory card, and battery unrelated.)

Start using

【Turn on Manually】

- No charging device connected.
- Insert the micro SD card into the memory card slot.

- Press power button to turn on, and WIFI/Power button light up in blue.

➤ Please insert the micro SD card before turn on



【 Shut down 】

- Press and hold WIFI/Power button for 5 seconds to turn off.
- Automatically shut down in 3 minutes in standby mode (setting in app).
- Do not remove the micro SD card during the shutdown process to avoid data damage.



【 LED indicator 】

Indicator light	color	Description
Power Indicator	blue	Light up-in standby
Recording indicator	red	Flashes-in recording
Charging Indicator	yellow	Flashes-in charging Light up-complete

【 Button Description 】

Button	Function
	Turn on/off the power(blue light)
	Start recording/stop recording (red light)

➤ Turn on the power:

- Press  button(1 second) to turn on the power(blue light is on).
- Press and hold  button for 3 seconds to shut down(The light is off).

➤ Start Recording:

- Power indicator light is on(blue),press  button to start recording video.

➤ (Blue light is on and red light flashes in recording video.)

➤ Save video:

- When the red light is flashing, press  button to save video files.

➤ (Return to standby after saving the video, and blue light is on.)

Connect with mobile phone

【 Download App 】



Searching and downloading "WCVR-PWD" from **App Store** or **Google Play** or **Official website** scan below QR code to get "WCVR-PWD" APP.



【 WIFI connection 】 and WCVR-PWD app

- **Start mobile phone WIFI function and search 【 WCVR_XXXXXX 】 device to establish a connection and without password. Then start the [WCVR-PWD] app to operate or setup Q20 ◦**

WCVR-PWD Instructions

1. WCVR will be displayed below the screen after successful connection.



1. Click on the icon to enter the video mode.



2. Start recording after entering the video mode, the red dot below will flash.



3. Click on the icon to enter the setting mode.



4. Settings mode:

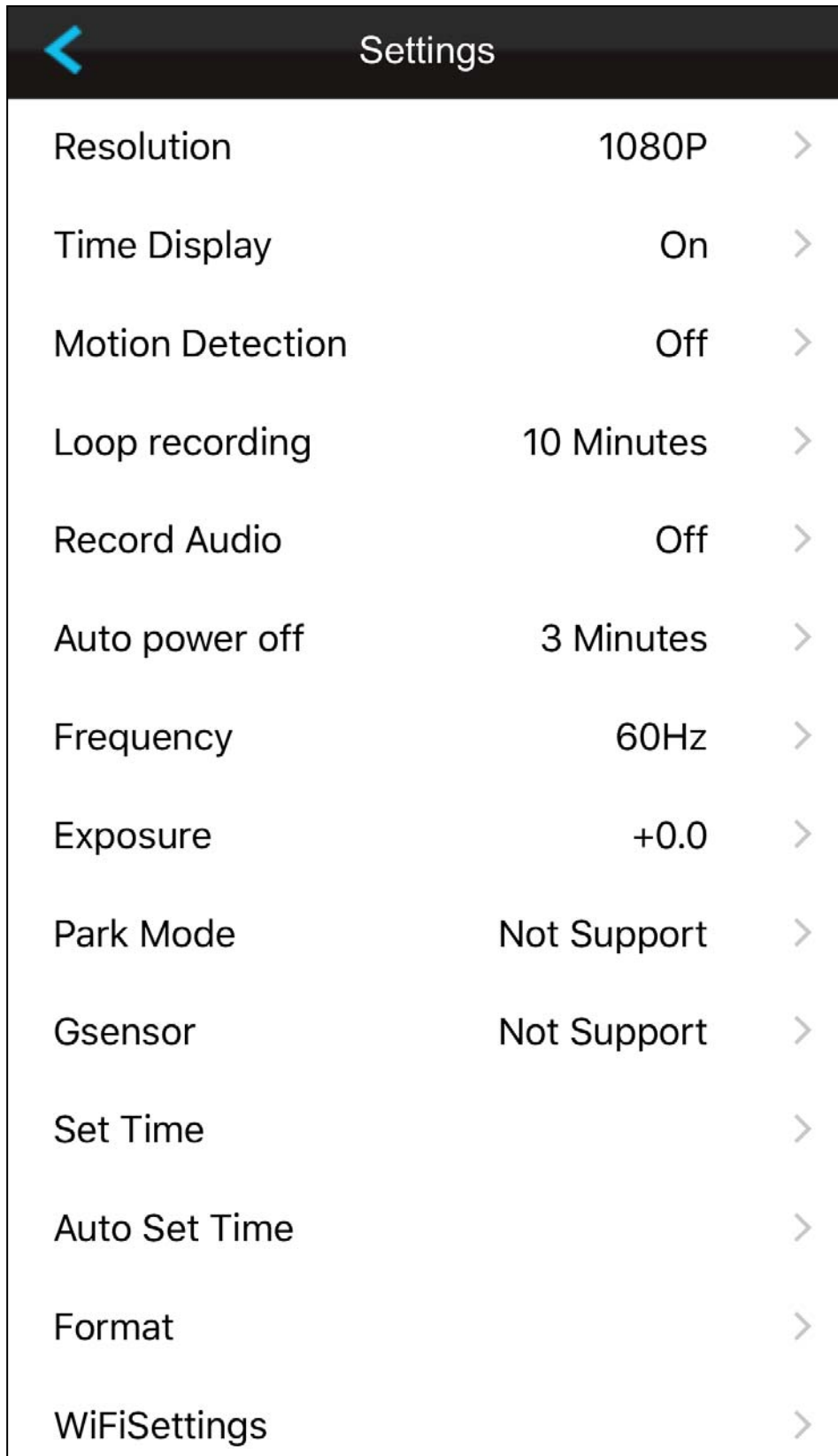

Settings	
Resolution	1080P >
Time Display	On >
Motion Detection	Off >
Loop recording	10 Minutes >
Record Audio	Off >
Auto power off	3 Minutes >
Frequency	60Hz >
Exposure	+0.0 >
Park Mode	Not Support >
Gsensor	Not Support >
Set Time	>
Auto Set Time	>
Format	>
WiFiSettings	>

5. In video recording, select the upper left button to manually save file and return to the main screen.



6. Return to the main screen and click the button below to enter the Preview mode.



7. In preview mode, click upper icon to read videos in memory card.

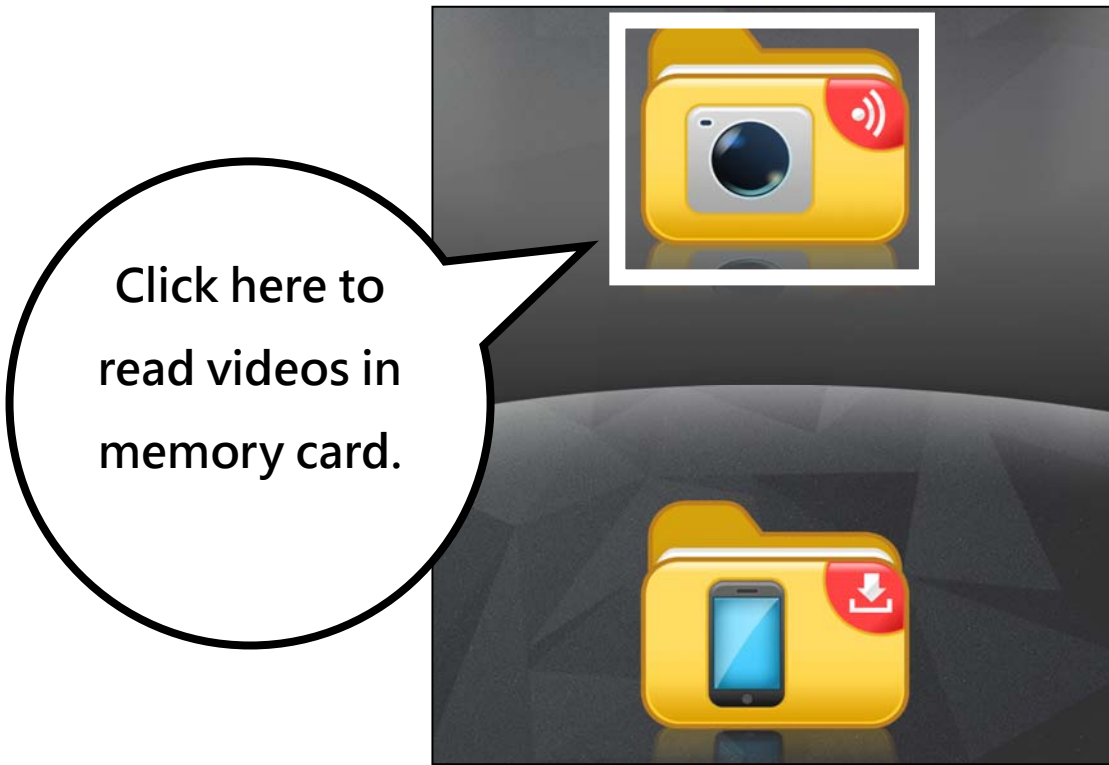

8. Click on the file you want to download and click on the download icon above to download the file to your phone.



9. Return to preview mode, click below icon to read videos that has been downloaded to the phone.

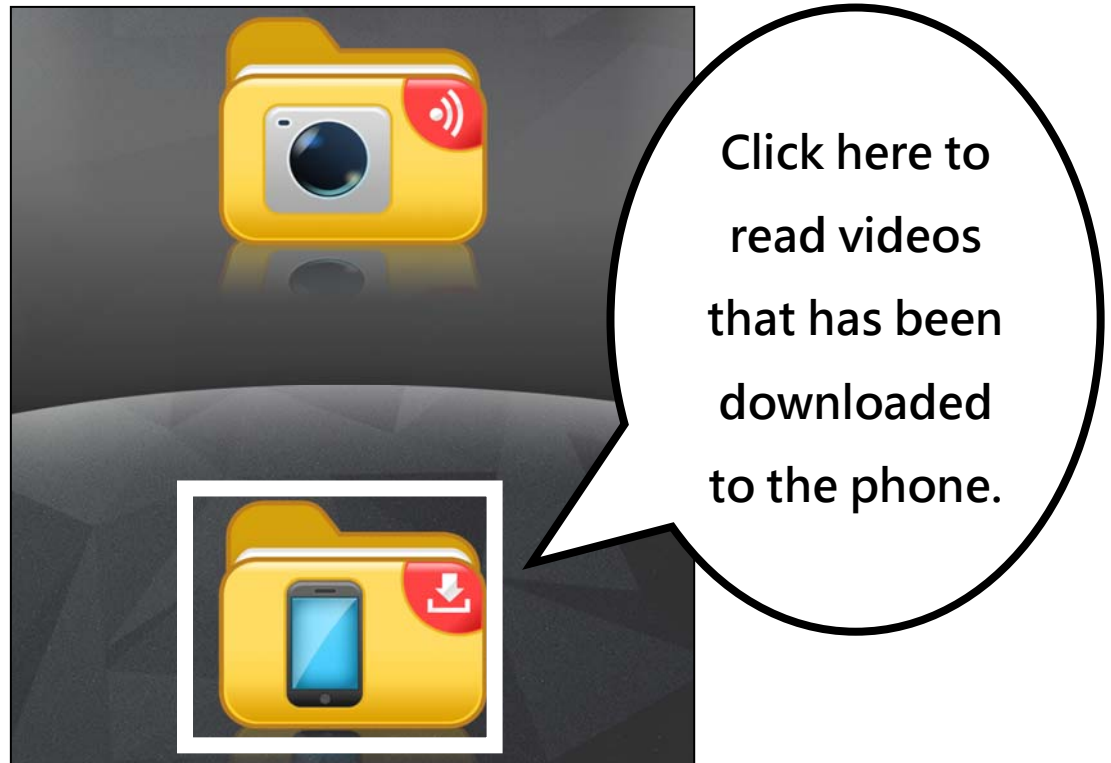

Please remove the memory card while charging.

Charging for 4 hours	
720P no WIFI	Recording for 260 mins
1080P no WIFI	Recording for 230 mins

	Q20 WIFI 1080P Sports Cam
Lens	Fixed focus 1.5 meters,glass,F1.8
	HD Low illumination CMOS sensor
Viewing angle	160 degrees

Q20 WIFI 1080P Sport Cam

Film resolution	1920 x 1080@30fps,1280 x 720@30fps
Video format	AVI
Exposure control	Adjustable(+2.0~-2.0)
Loop recording	Cycle time adjustable
White balance	Auto
WIFI	2.4Ghz,P2P
WIFI effective distance	2~5m
APP support system	iPhone iOS 8.0 or above, Android 4.0 or newer
Video transmission	uploaded from phone
Memory card	Micro SD/SDHC (class6 above) Max 32GB
Power supply	USB Adapter(INPUT : 110V-240V)
Battery	Rechargeable lithium battery
Operating temperature	0~60°C
Pace of production	China

✧ **We only provides hardware warranty and maintenance for this machine, please back up your data before sending it for repair.**